

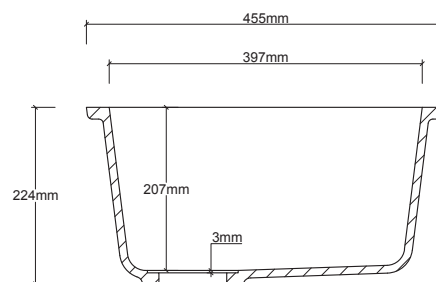

# Durasein

## Sink & Bowl Information

NAME  
THE JOHANN  
MODEL  
RLD104  
TOLERANCE  
±5MM

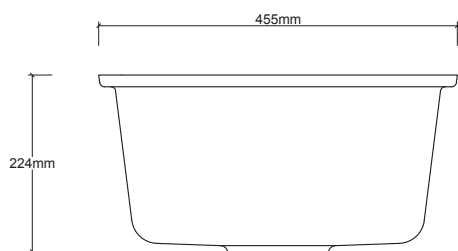

A-A

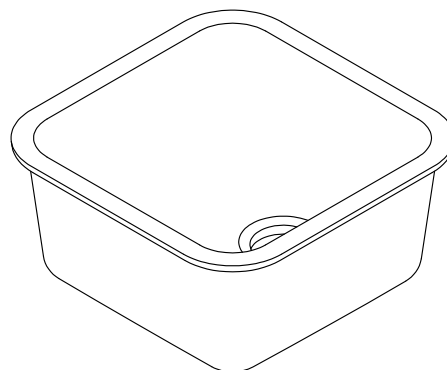
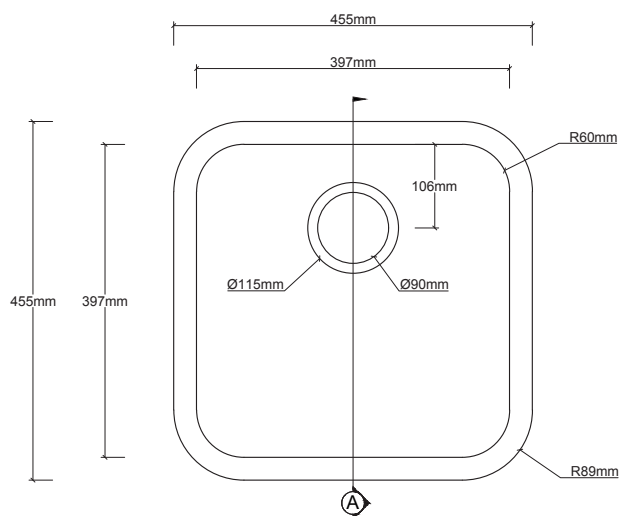



# Durasein

## Sink & Bowl Information

MODEL  
RLD104

### Features & Benefits

- 100% acrylic
- Easy to clean
- Non-porous
- Stain resistant
- Mould & mildew resistant
- Suitable for residential & commercial applications
- Integral overflow : no

### Installation Tips

- Undermount
- No tap holes
- Drain assembly not included
- Drain hole size: 90mm

### Available Colours

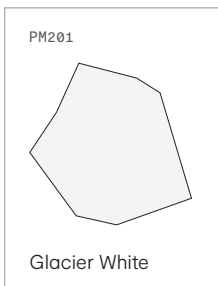

Colour shown may vary from actual product. Request sample prior to product selection. We'd love to create something a little more custom for you, longer lead times with minimum order quantity applies.

### Codes/Standards/Tech Info

- Durasein sinks and bowls are UKCA & CE compliant
- All dimensions are nominal
- Details and specifications are subject to change

### Internal Dimensions

- Length 397mm
- Width 397mm
- Height 207mm

### Durasein Limited Warranty

- 10 year limited warranty against manufacturing defects under normal use

See website for detailed warranty information. Durasein reserves the right to make reservations without notice to product specifications. For the most current information, for to [durasein.co.uk](http://durasein.co.uk).



# Durasein

## Sink & Bowl Information

NAME  
THE JOHANN  
MODEL  
RLD104A  
TOLERANCE  
±5MM

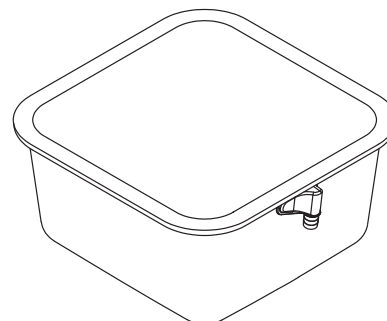
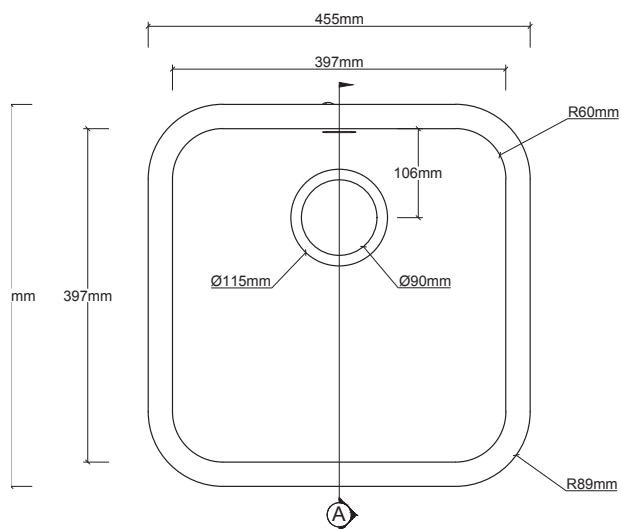
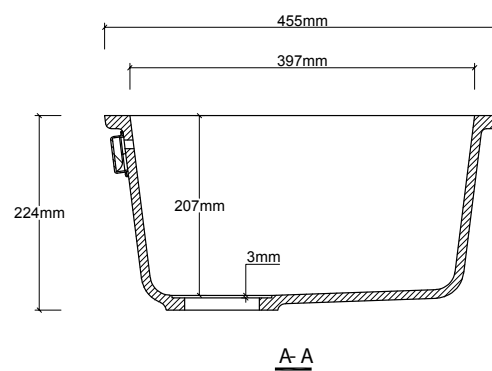
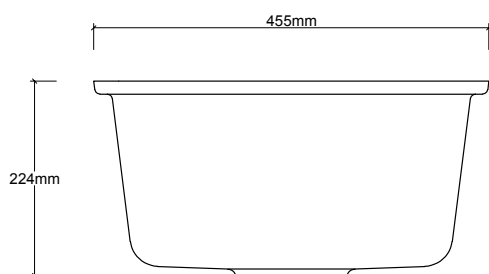



# Durasein

## Sink & Bowl Information

MODEL  
RLD104A

### Features & Benefits

- 100% acrylic
- Easy to clean
- Non-porous
- Stain resistant
- Mould & mildew resistant
- Suitable for residential & commercial applications
- Integral overflow : no ; overflow : yes

### Installation Tips

- Undermount
- No tap holes
- Drain assembly not included
- Drain hole size: 90mm

### Available Colours

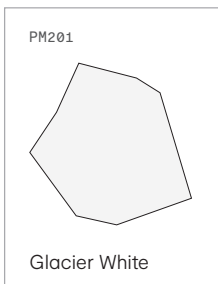

Colour shown may vary from actual product. Request sample prior to product selection. We'd love to create something a little more custom for you, longer lead times with minimum order quantity applies.

### Codes/Standards/Tech Info

- Durasein sinks and bowls are UKCA & CE compliant
- All dimensions are nominal
- Details and specifications are subject to change

### Internal Dimensions

- Length 397mm
- Width 397mm
- Height 207mm

### Durasein Limited Warranty

- 10 year limited warranty against manufacturing defects under normal use

See website for detailed warranty information. Durasein reserves the right to make reservations without notice to product specifications. For the most current information, for to [durasein.co.uk](http://durasein.co.uk).



# Durasein

## Sink & Bowl Information

NAME  
THE ALBERT  
MODEL  
RLD127  
TOLERANCE  
±5MM

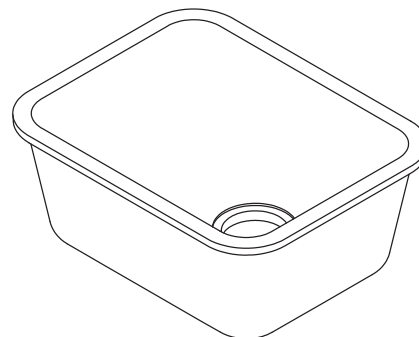
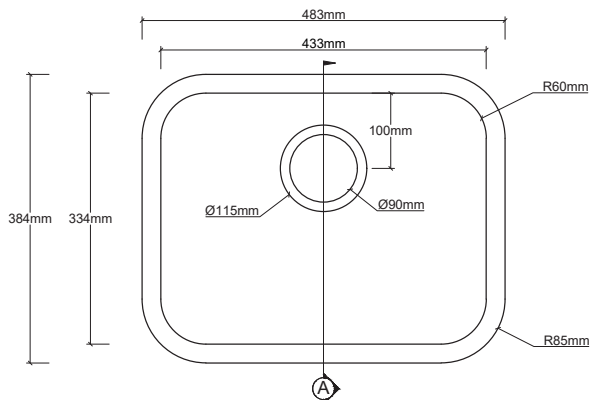
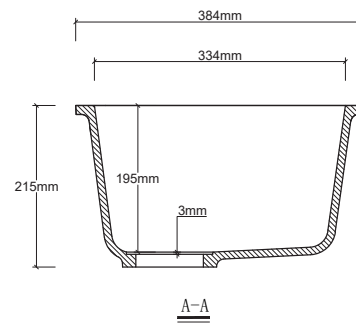
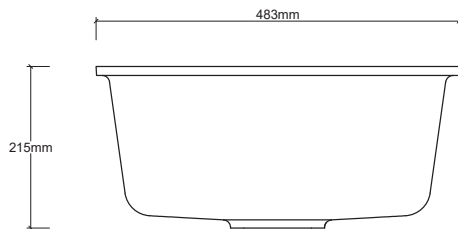



# Durasein

## Sink & Bowl Information

MODEL  
RLD127

### Features & Benefits

- 100% acrylic
- Easy to clean
- Non-porous
- Stain resistant
- Mould & mildew resistant
- Suitable for residential & commercial applications
- Integral overflow : no

### Installation Tips

- Undermount
- No tap holes
- Drain assembly not included
- Drain hole size: 90mm

### Available Colours

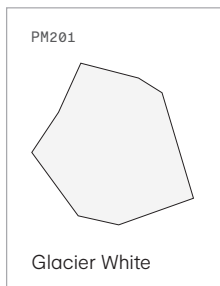

Colour shown may vary from actual product. Request sample prior to product selection. We'd love to create something a little more custom for you, longer lead times with minimum order quantity applies.

### Codes/Standards/Tech Info

- Durasein sinks and bowls are UKCA & CE compliant
- All dimensions are nominal
- Details and specifications are subject to change

### Internal Dimensions

- Length 433mm
- Width 334mm
- Height 195mm

### Durasein Limited Warranty

- 10 year limited warranty against manufacturing defects under normal use

See website for detailed warranty information. Durasein reserves the right to make reservations without notice to product specifications. For the most current information, for to [durasein.co.uk](http://durasein.co.uk).



# Durasein

## Sink & Bowl Information

NAME  
THE ALBERT  
MODEL  
RLD127A  
TOLERANCE  
±5MM

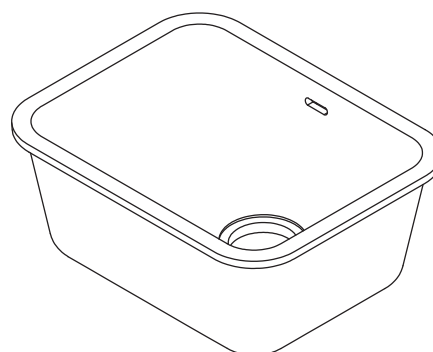
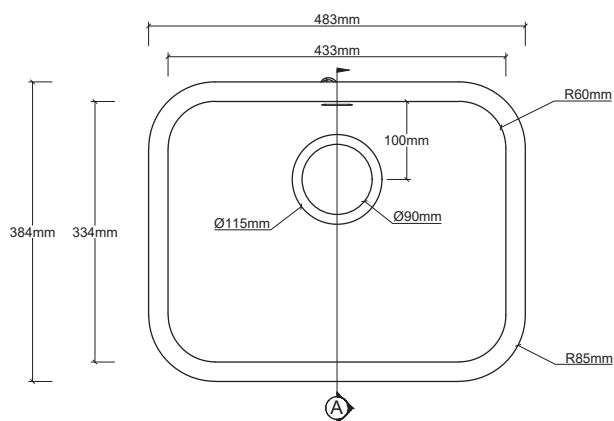
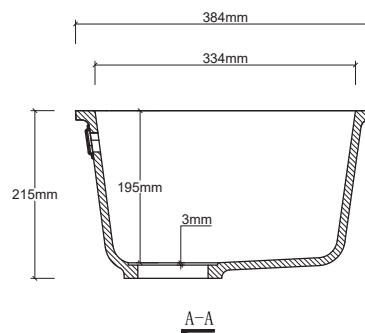
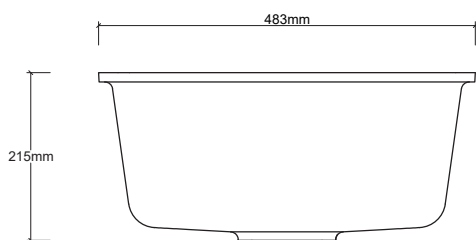



# Durasein

## Sink & Bowl Information

MODEL  
RLD127A

### Features & Benefits

- 100% acrylic
- Easy to clean
- Non-porous
- Stain resistant
- Mould & mildew resistant
- Suitable for residential & commercial applications
- Integral overflow : no ; overflow : yes

### Installation Tips

- Undermount
- No tap holes
- Drain assembly not included
- Drain hole size: 90mm

### Available Colours

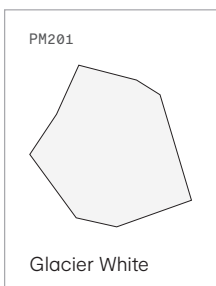

Colour shown may vary from actual product. Request sample prior to product selection. We'd love to create something a little more custom for you, longer lead times with minimum order quantity applies.

### Codes/Standards/Tech Info

- Durasein sinks and bowls are UKCA & CE compliant
- All dimensions are nominal
- Details and specifications are subject to change

### Internal Dimensions

- Length 433mm
- Width 334mm
- Height 195mm

### Durasein Limited Warranty

- 10 year limited warranty against manufacturing defects under normal use

See website for detailed warranty information. Durasein reserves the right to make reservations without notice to product specifications. For the most current information, for to [durasein.co.uk](http://durasein.co.uk).





# Durasein

## Sink & Bowl Information

NAME  
THE CLAUDE  
MODEL  
RLD120A  
TOLERANCE  
±5MM

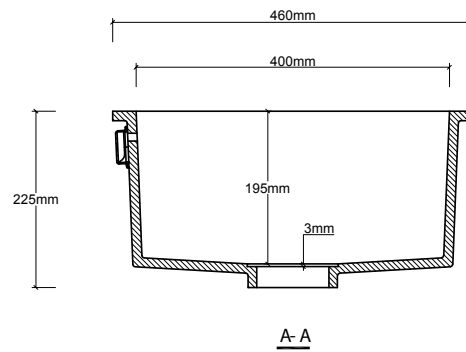
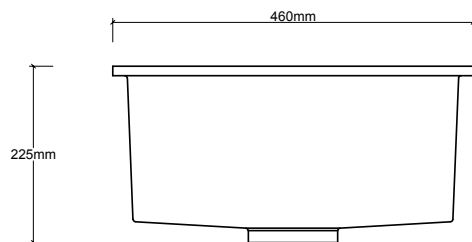

A-A

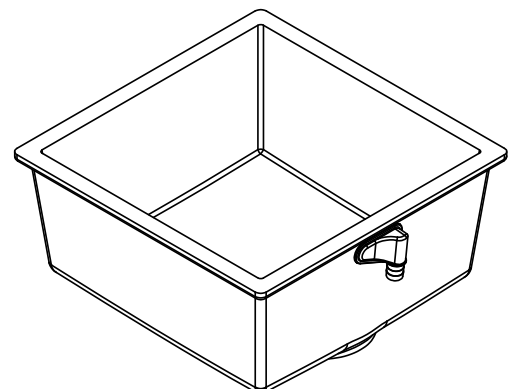
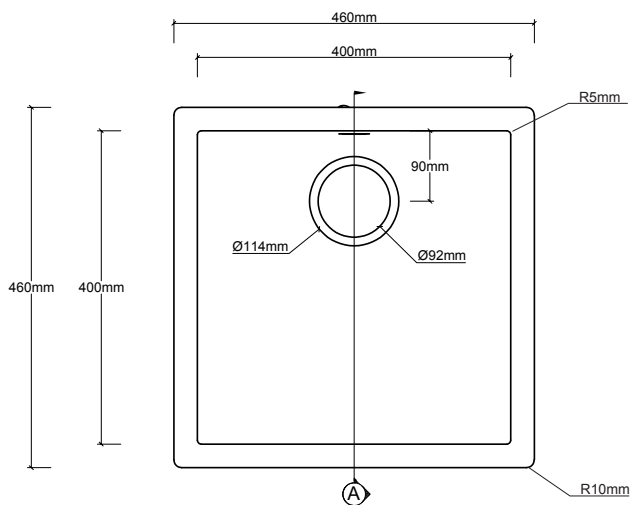



# Durasein

## Sink & Bowl Information

MODEL  
RLD120A

### Features & Benefits

- 100% acrylic
- Easy to clean
- Non-porous
- Stain resistant
- Mould & mildew resistant
- Suitable for residential & commercial applications
- Integral overflow : no ; overflow : yes

### Installation Tips

- Undermount
- No tap holes
- Drain assembly not included
- Drain hole size: 92mm

### Available Colours

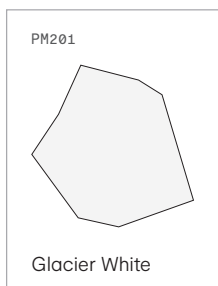

Colour shown may vary from actual product. Request sample prior to product selection. We'd love to create something a little more custom for you, longer lead times with minimum order quantity applies.

### Codes/Standards/Tech Info

- Durasein sinks and bowls are UKCA & CE compliant
- All dimensions are nominal
- Details and specifications are subject to change

### Internal Dimensions

- Length 400mm
- Width 400mm
- Height 195mm

### Durasein Limited Warranty

- 10 year limited warranty against manufacturing defects under normal use

See website for detailed warranty information. Durasein reserves the right to make reservations without notice to product specifications. For the most current information, for to [durasein.co.uk](http://durasein.co.uk).



# Durasein

## Sink & Bowl Information

NAME  
THE WILLIAM  
MODEL  
RLD147A  
TOLERANCE  
±5MM

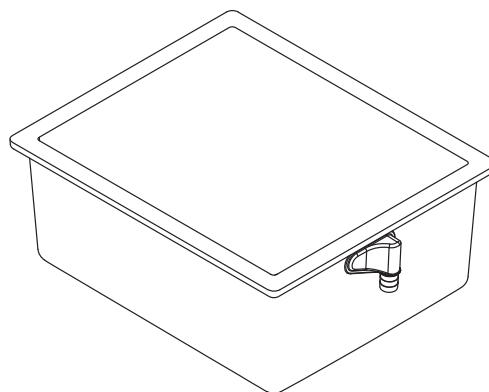
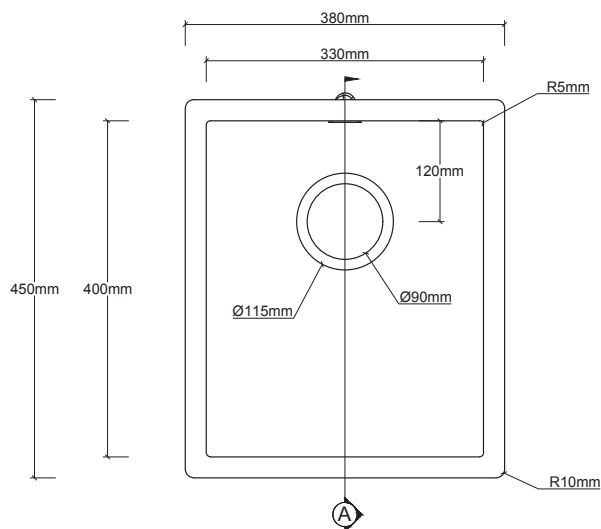
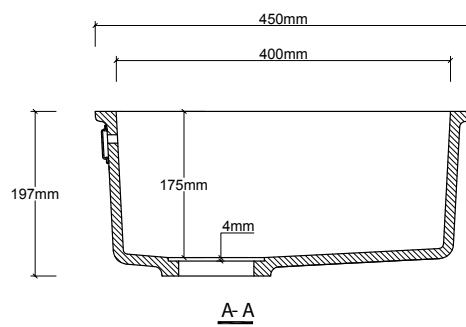
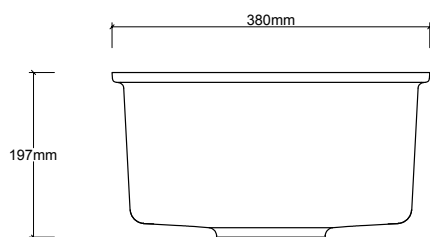



# Durasein

## Sink & Bowl Information

MODEL  
RLD147A

### Features & Benefits

- 100% acrylic
- Easy to clean
- Non-porous
- Stain resistant
- Mould & mildew resistant
- Suitable for residential & commercial applications
- Integral overflow : no ; overflow : yes

### Installation Tips

- Undermount
- No tap holes
- Drain assembly not included
- Drain hole size: 90mm

### Available Colours

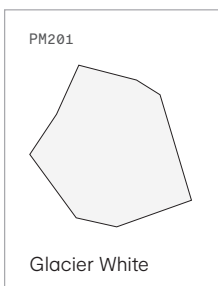

Colour shown may vary from actual product. Request sample prior to product selection. We'd love to create something a little more custom for you, longer lead times with minimum order quantity applies.

### Codes/Standards/Tech Info

- Durasein sinks and bowls are UKCA & CE compliant
- All dimensions are nominal
- Details and specifications are subject to change

### Internal Dimensions

- Length 330mm
- Width 400mm
- Height 175mm

### Durasein Limited Warranty

- 10 year limited warranty against manufacturing defects under normal use

See website for detailed warranty information. Durasein reserves the right to make reservations without notice to product specifications. For the most current information, for to [durasein.co.uk](http://durasein.co.uk).



# Durasein

## Sink & Bowl Information

NAME  
THE CHARLES  
MODEL  
RLD215A  
TOLERANCE  
±5MM

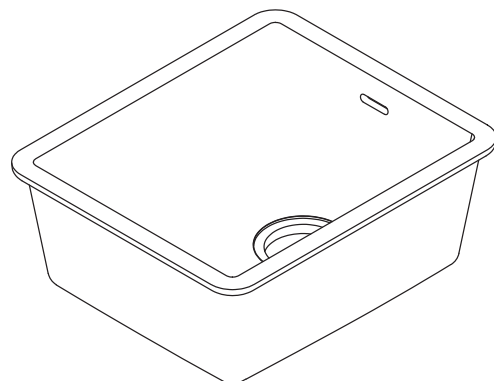
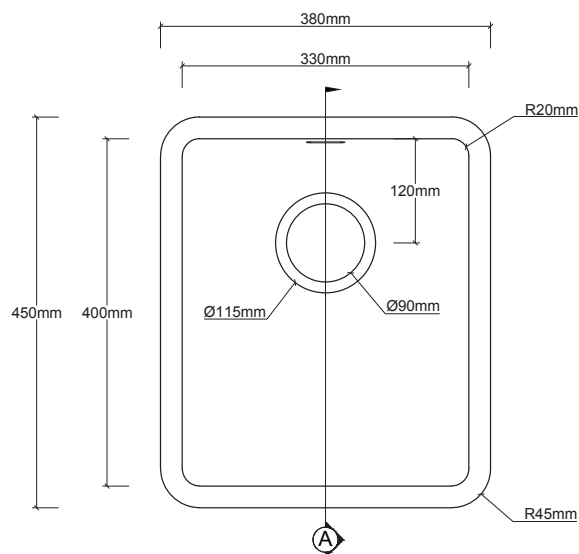
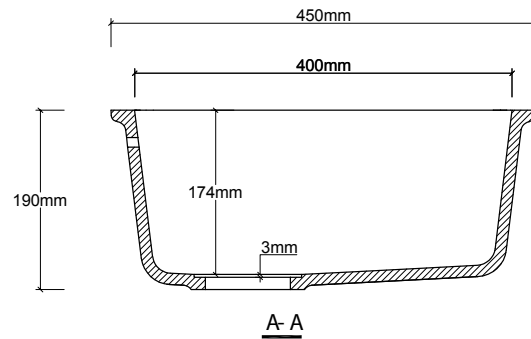
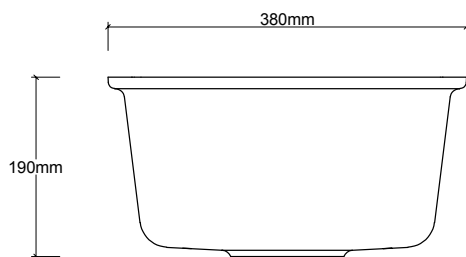



# Durasein

## Sink & Bowl Information

MODEL  
RLD215A

### Features & Benefits

- 100% acrylic
- Easy to clean
- Non-porous
- Stain resistant
- Mould & mildew resistant
- Suitable for residential & commercial applications
- Integral overflow : no ; overflow : yes

### Installation Tips

- Undermount
- No tap holes
- Drain assembly not included
- Drain hole size: 90mm

### Available Colours

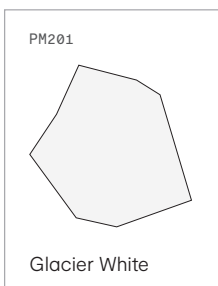

Colour shown may vary from actual product. Request sample prior to product selection. We'd love to create something a little more custom for you, longer lead times with minimum order quantity applies.

### Codes/Standards/Tech Info

- Durasein sinks and bowls are UKCA & CE compliant
- All dimensions are nominal
- Details and specifications are subject to change

### Internal Dimensions

- Length 330mm
- Width 400mm
- Height 174mm

### Durasein Limited Warranty

- 10 year limited warranty against manufacturing defects under normal use

See website for detailed warranty information. Durasein reserves the right to make reservations without notice to product specifications. For the most current information, for to [durasein.co.uk](http://durasein.co.uk).



# Durasein

## Sink & Bowl Information

NAME  
THE LEWIS  
MODEL  
RLD216A  
TOLERANCE  
±5MM

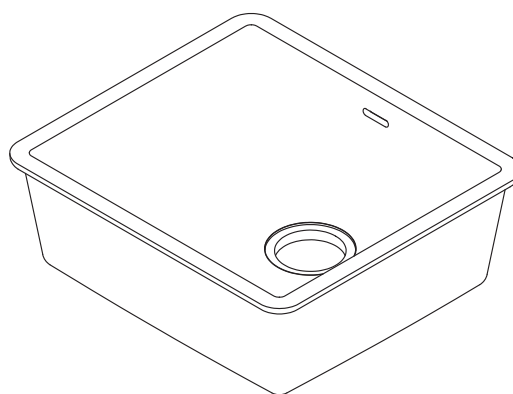
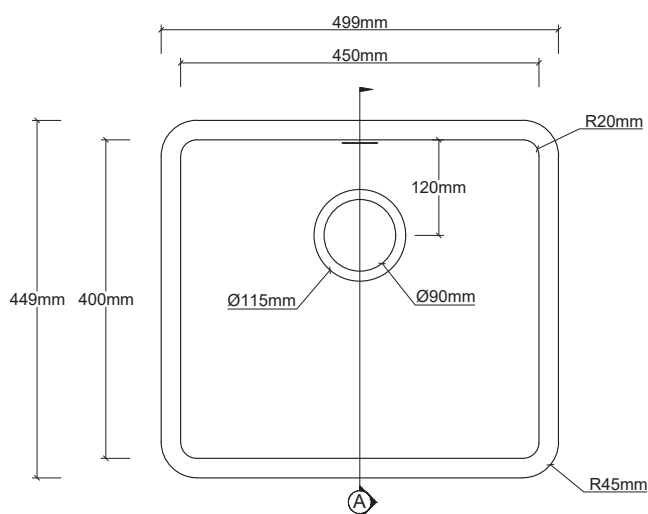
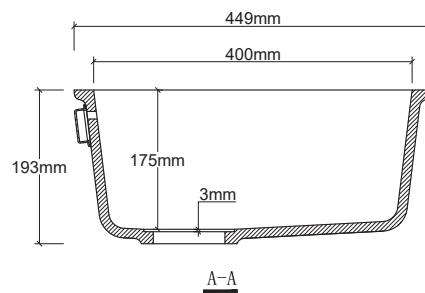
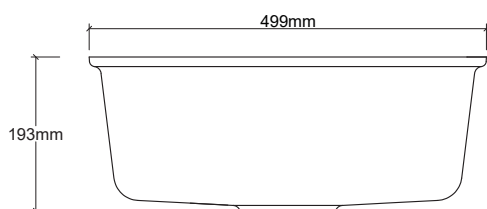



# Durasein

## Sink & Bowl Information

MODEL  
RLD216A

### Features & Benefits

- 100% acrylic
- Easy to clean
- Non-porous
- Stain resistant
- Mould & mildew resistant
- Suitable for residential & commercial applications
- Integral overflow : no

### Installation Tips

- Undermount
- No tap holes
- Drain assembly not included
- Drain hole size: 90mm

### Available Colours

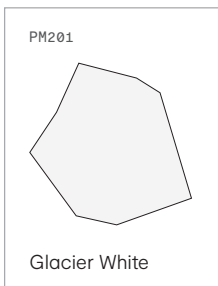

Colour shown may vary from actual product. Request sample prior to product selection. We'd love to create something a little more custom for you, longer lead times with minimum order quantity applies.

### Codes/Standards/Tech Info

- Durasein sinks and bowls are UKCA & CE compliant
- All dimensions are nominal
- Details and specifications are subject to change

### Internal Dimensions

- Length 450mm
- Width 400mm
- Height 175mm

### Durasein Limited Warranty

- 10 year limited warranty against manufacturing defects under normal use

See website for detailed warranty information. Durasein reserves the right to make reservations without notice to product specifications. For the most current information, for to [durasein.co.uk](http://durasein.co.uk).





# Durasein

## Sink & Bowl Information

NAME  
THE MARIE  
MODEL  
RLD126  
TOLERANCE  
±5MM

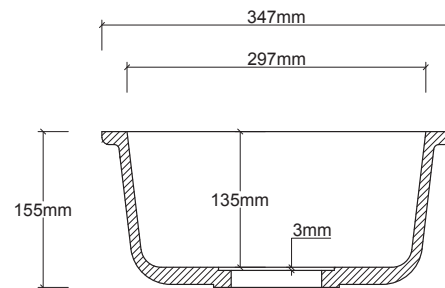
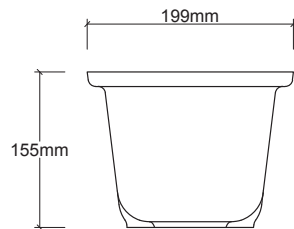

A-A

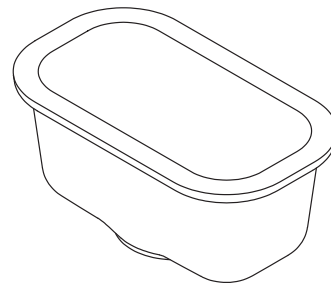
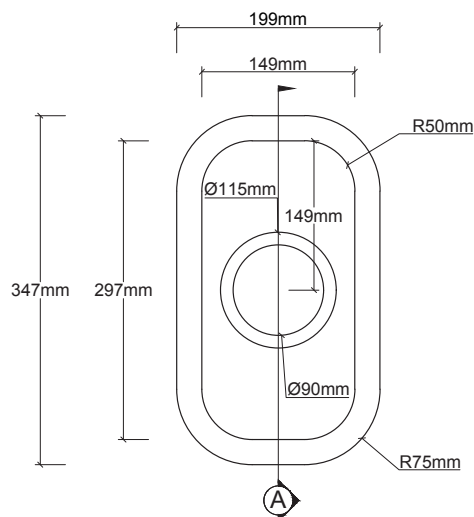



# Durasein

## Sink & Bowl Information

MODEL  
RLD126

### Features & Benefits

- 100% acrylic
- Easy to clean
- Non-porous
- Stain resistant
- Mould & mildew resistant
- Suitable for residential & commercial applications
- Integral overflow : no

### Installation Tips

- Undermount
- No tap holes
- Drain assembly not included
- Drain hole size: 90mm

### Available Colours

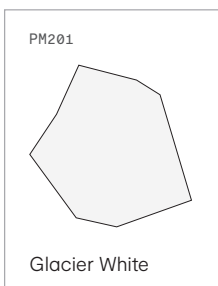

Colour shown may vary from actual product. Request sample prior to product selection. We'd love to create something a little more custom for you, longer lead times with minimum order quantity applies.

### Codes/Standards/Tech Info

- Durasein sinks and bowls are UKCA & CE compliant
- All dimensions are nominal
- Details and specifications are subject to change

### Internal Dimensions

- Length 149mm
- Width 297mm
- Height 135mm

### Durasein Limited Warranty

- 10 year limited warranty against manufacturing defects under normal use

See website for detailed warranty information. Durasein reserves the right to make reservations without notice to product specifications. For the most current information, for to [durasein.co.uk](http://durasein.co.uk).



# Durasein

## Sink & Bowl Information

NAME  
THE MARIE  
MODEL  
RLD126A  
TOLERANCE  
±5MM

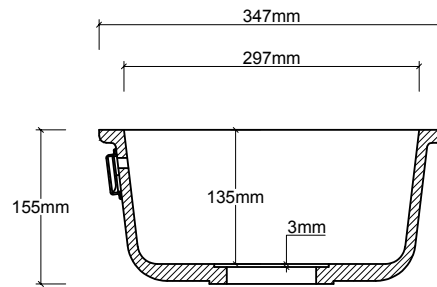
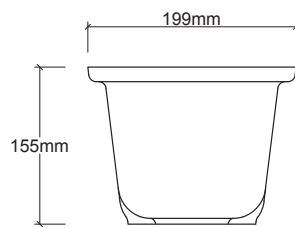

A-A

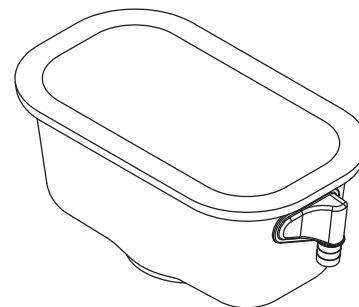
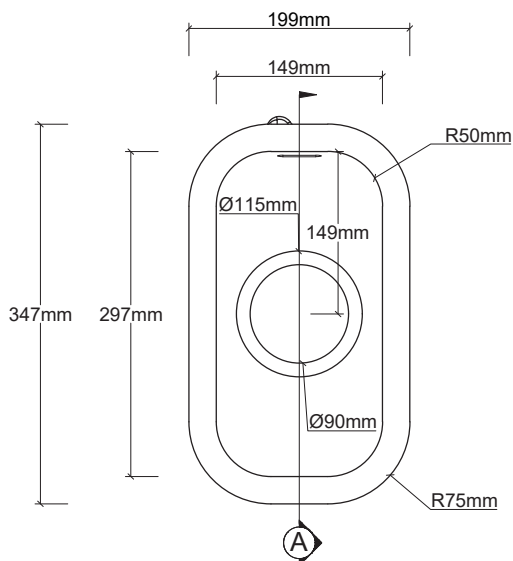



# Durasein

## Sink & Bowl Information

MODEL  
RLD126A

### Features & Benefits

- 100% acrylic
- Easy to clean
- Non-porous
- Stain resistant
- Mould & mildew resistant
- Suitable for residential & commercial applications
- Integral overflow : no ; overflow : yes

### Installation Tips

- Undermount
- No tap holes
- Drain assembly not included
- Drain hole size: 90mm

### Available Colours

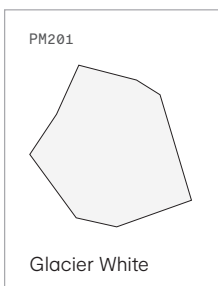

Colour shown may vary from actual product. Request sample prior to product selection. We'd love to create something a little more custom for you, longer lead times with minimum order quantity applies.

### Codes/Standards/Tech Info

- Durasein sinks and bowls are UKCA & CE compliant
- All dimensions are nominal
- Details and specifications are subject to change

### Internal Dimensions

- Length 149mm
- Width 297mm
- Height 135mm

### Durasein Limited Warranty

- 10 year limited warranty against manufacturing defects under normal use

See website for detailed warranty information. Durasein reserves the right to make reservations without notice to product specifications. For the most current information, for to [durasein.co.uk](http://durasein.co.uk).



# Durasein

## Sink & Bowl Information

NAME  
THE JANE  
MODEL  
RLD146  
TOLERANCE  
±5MM

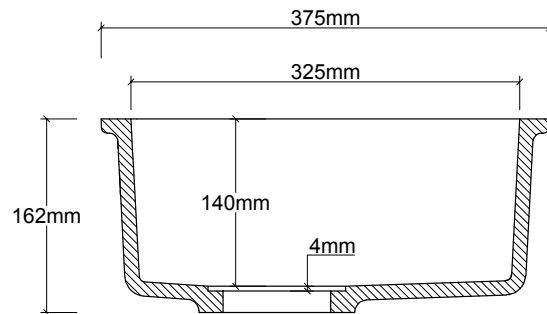
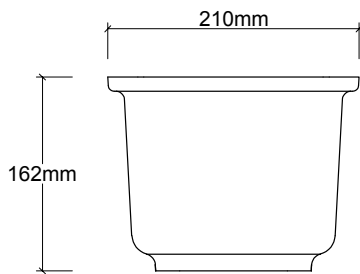

A-A

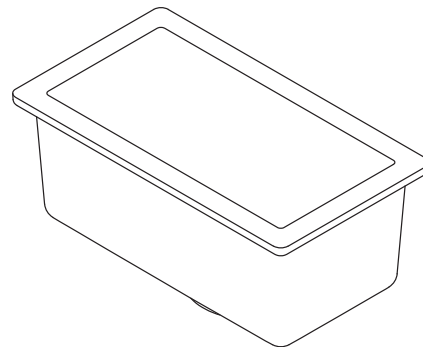
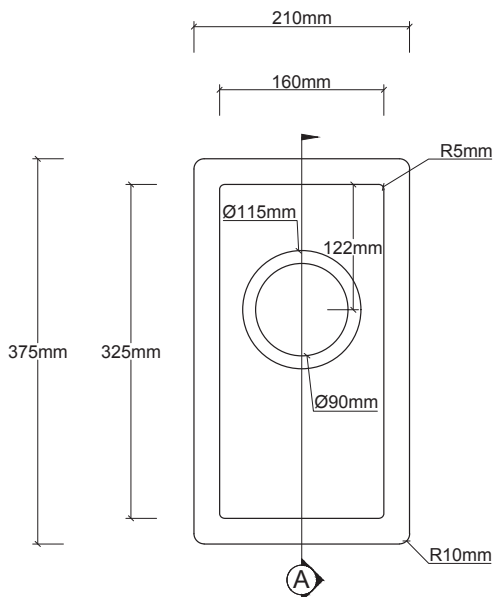



# Durasein

## Sink & Bowl Information

MODEL  
RLD146

### Features & Benefits

- 100% acrylic
- Easy to clean
- Non-porous
- Stain resistant
- Mould & mildew resistant
- Suitable for residential & commercial applications
- Integral overflow : no

### Installation Tips

- Undermount
- No tap holes
- Drain assembly not included
- Drain hole size: 90mm

### Available Colours

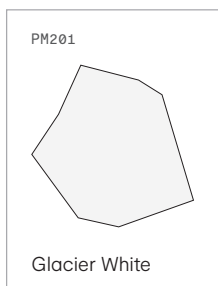

Colour shown may vary from actual product. Request sample prior to product selection. We'd love to create something a little more custom for you, longer lead times with minimum order quantity applies.

### Codes/Standards/Tech Info

- Durasein sinks and bowls are UKCA & CE compliant
- All dimensions are nominal
- Details and specifications are subject to change

### Internal Dimensions

- Length 160mm
- Width 325mm
- Height 140mm

### Durasein Limited Warranty

- 10 year limited warranty against manufacturing defects under normal use

See website for detailed warranty information. Durasein reserves the right to make reservations without notice to product specifications. For the most current information, for to [durasein.co.uk](https://durasein.co.uk).



# Durasein

## Sink & Bowl Information

NAME  
THE JANE  
MODEL  
RLD146A  
TOLERANCE  
±5MM

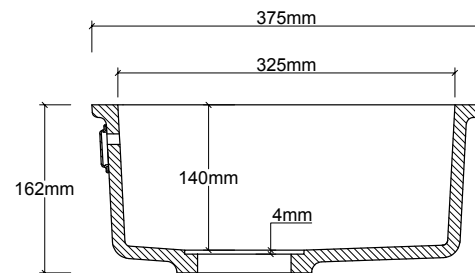
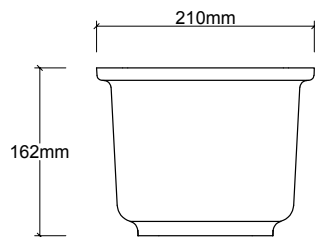

A-A

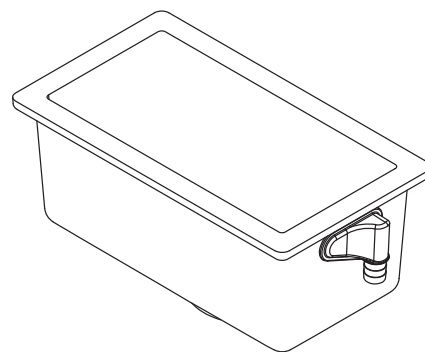
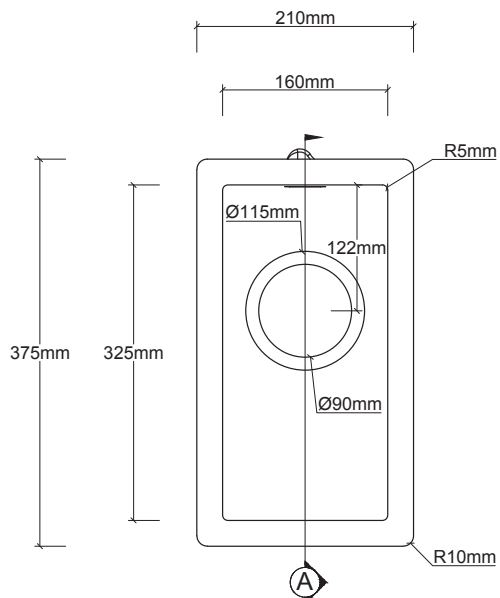



# Durasein

## Sink & Bowl Information

MODEL  
RLD146A

### Features & Benefits

- 100% acrylic
- Easy to clean
- Non-porous
- Stain resistant
- Mould & mildew resistant
- Suitable for residential & commercial applications
- Integral overflow : no ; overflow : yes

### Installation Tips

- Undermount
- No tap holes
- Drain assembly not included
- Drain hole size: 90mm

### Available Colours

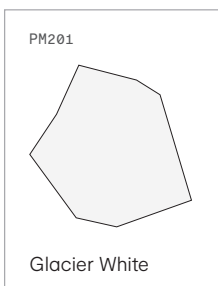

Colour shown may vary from actual product. Request sample prior to product selection. We'd love to create something a little more custom for you, longer lead times with minimum order quantity applies.

### Codes/Standards/Tech Info

- Durasein sinks and bowls are UKCA & CE compliant
- All dimensions are nominal
- Details and specifications are subject to change

### Internal Dimensions

- Length 160mm
- Width 325mm
- Height 140mm

### Durasein Limited Warranty

- 10 year limited warranty against manufacturing defects under normal use

See website for detailed warranty information. Durasein reserves the right to make reservations without notice to product specifications. For the most current information, for to [durasein.co.uk](http://durasein.co.uk).





# Durasein

## Sink & Bowl Information

NAME  
THE ALEXANDER  
MODEL  
RLD131A  
TOLERANCE  
±5MM

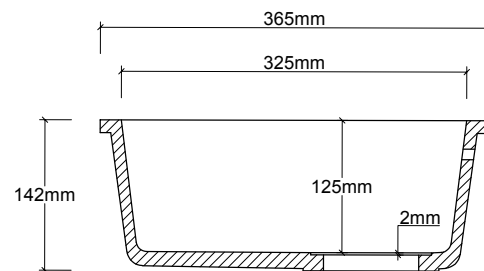
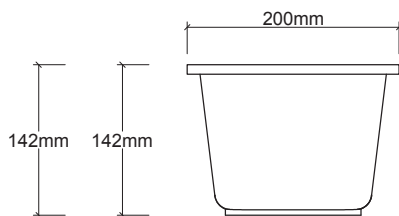
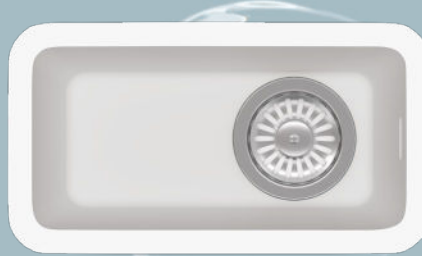

A-A

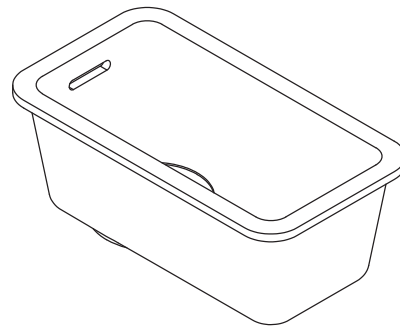
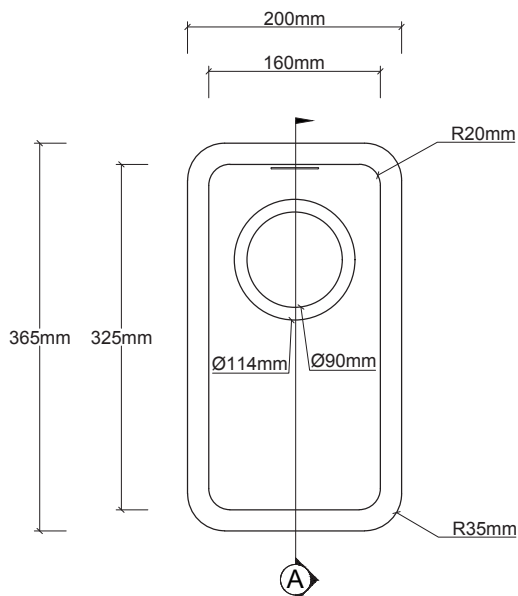



# Durasein

## Sink & Bowl Information

MODEL  
RLD131A

### Features & Benefits

- 100% acrylic
- Easy to clean
- Non-porous
- Stain resistant
- Mould & mildew resistant
- Suitable for residential & commercial applications
- Integral overflow : no ; overflow : yes

### Installation Tips

- Undermount
- No tap holes
- Drain assembly not included
- Drain hole size: 90mm

### Available Colours

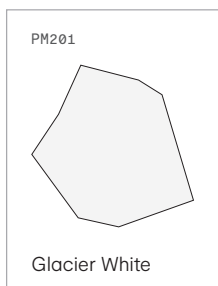

Colour shown may vary from actual product. Request sample prior to product selection. We'd love to create something a little more custom for you, longer lead times with minimum order quantity applies.

### Codes/Standards/Tech Info

- Durasein sinks and bowls are UKCA & CE compliant
- All dimensions are nominal
- Details and specifications are subject to change

### Internal Dimensions

- Length 160mm
- Width 325mm
- Height 125mm

### Durasein Limited Warranty

- 10 year limited warranty against manufacturing defects under normal use

See website for detailed warranty information. Durasein reserves the right to make reservations without notice to product specifications. For the most current information, for to [durasein.co.uk](http://durasein.co.uk).



# Durasein

## Sink & Bowl Information

NAME  
THE LEO  
MODEL  
RLA100  
TOLERANCE  
±5MM

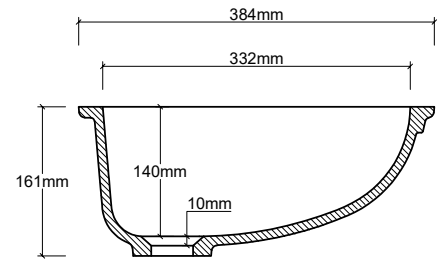
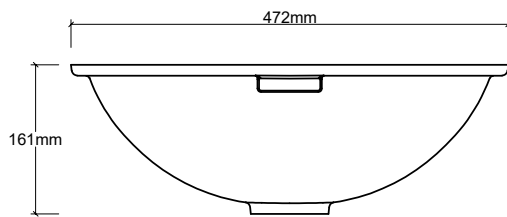

A-A

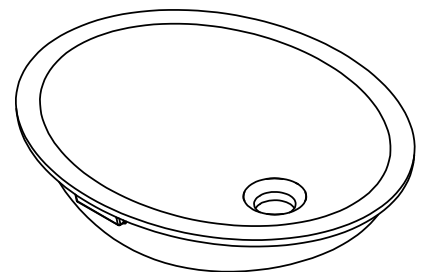
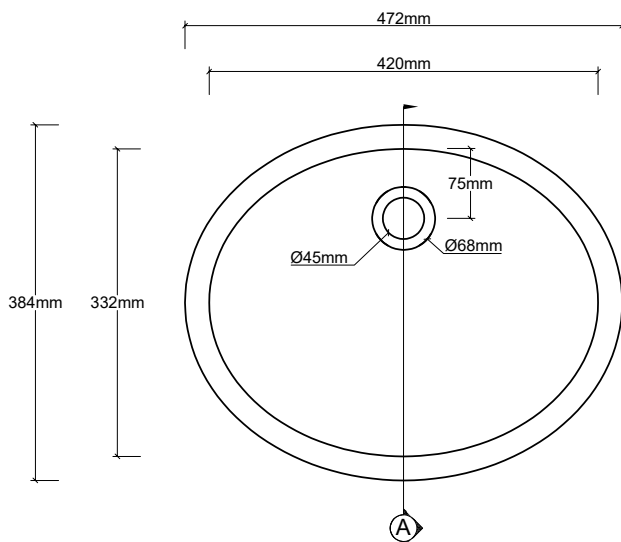



# Durasein

## Sink & Bowl Information

MODEL  
RLA100

### Features & Benefits

- 100% acrylic
- Easy to clean
- Non-porous
- Stain resistant
- Mould & mildew resistant
- Suitable for residential & commercial applications
- Integral overflow : no

### Installation Tips

- Undermount
- No tap holes
- Drain assembly not included
- Drain hole size: 45mm

### Available Colours

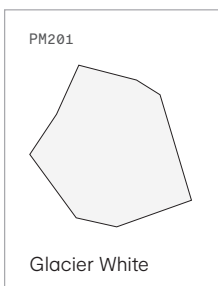

Colour shown may vary from actual product. Request sample prior to product selection. We'd love to create something a little more custom for you, longer lead times with minimum order quantity applies.

### Codes/Standards/Tech Info

- Durasein sinks and bowls are UKCA & CE compliant
- All dimensions are nominal
- Details and specifications are subject to change

### Internal Dimensions

- Length 420mm
- Width 332mm
- Height 140mm

### Durasein Limited Warranty

- 10 year limited warranty against manufacturing defects under normal use

See website for detailed warranty information. Durasein reserves the right to make reservations without notice to product specifications. For the most current information, for to [durasein.co.uk](http://durasein.co.uk).



# Durasein

## Sink & Bowl Information

NAME  
THE PABLO  
MODEL  
RLA104A  
TOLERANCE  
±5MM

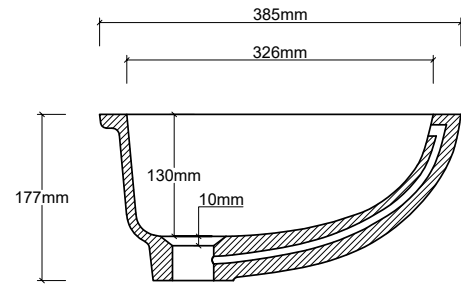
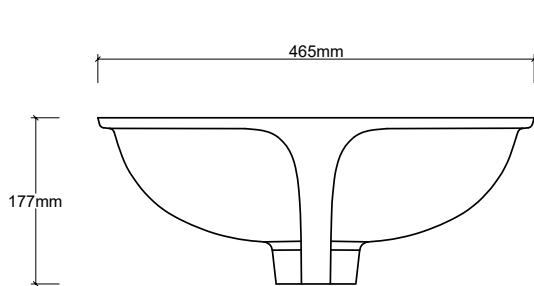

A-A

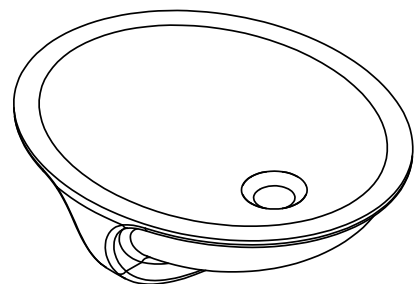
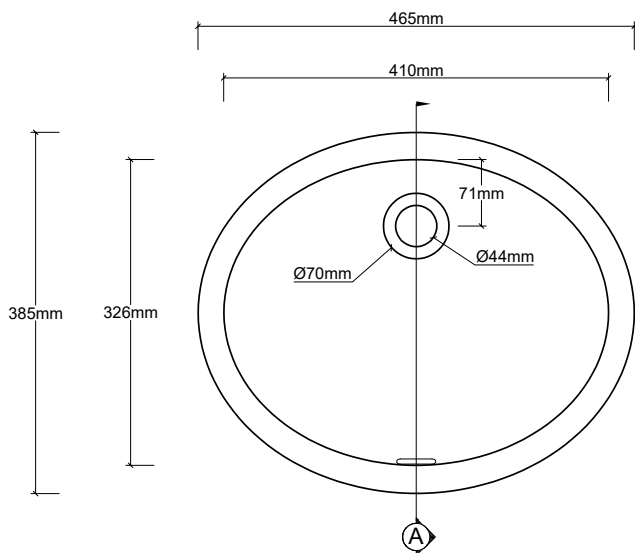



# Durasein

## Sink & Bowl Information

MODEL  
RLA104A

### Features & Benefits

- 100% acrylic
- Easy to clean
- Non-porous
- Stain resistant
- Mould & mildew resistant
- Suitable for residential & commercial applications
- Integral overflow : yes

### Installation Tips

- Undermount
- No tap holes
- Drain assembly not included
- Drain hole size: 44mm

### Available Colours

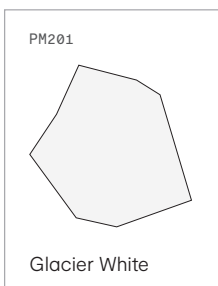

Colour shown may vary from actual product. Request sample prior to product selection. We'd love to create something a little more custom for you, longer lead times with minimum order quantity applies.

### Codes/Standards/Tech Info

- Durasein sinks and bowls are UKCA & CE compliant
- All dimensions are nominal
- Details and specifications are subject to change

### Internal Dimensions

- Length 410mm
- Width 326mm
- Height 130mm

### Durasein Limited Warranty

- 10 year limited warranty against manufacturing defects under normal use

See website for detailed warranty information. Durasein reserves the right to make reservations without notice to product specifications. For the most current information, for to [durasein.co.uk](http://durasein.co.uk).



# Durasein

## Sink & Bowl Information

NAME  
THE YOKO  
MODEL  
RLA106A  
TOLERANCE  
±5MM

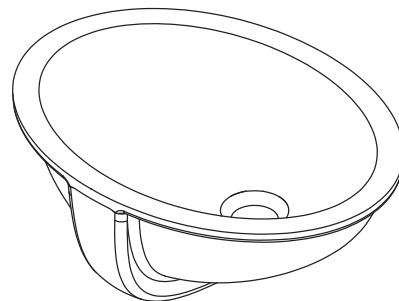
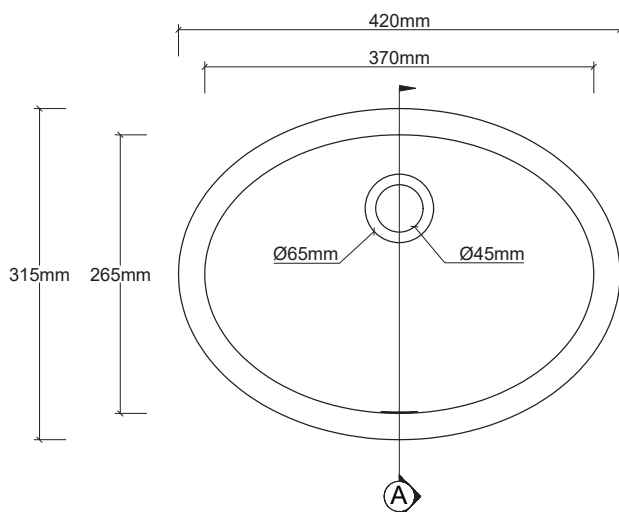
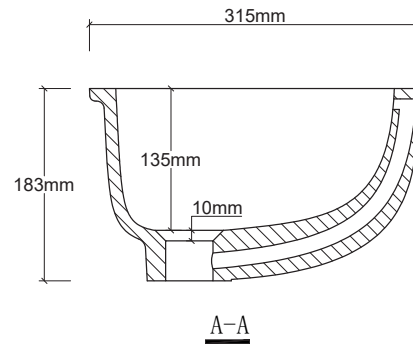
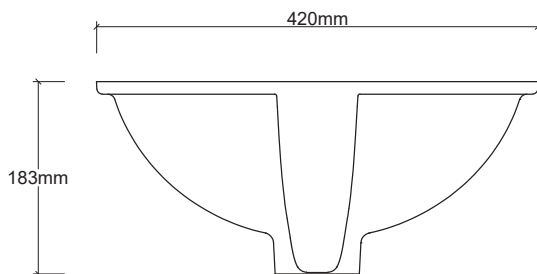



# Durasein

## Sink & Bowl Information

MODEL  
RLA106A

### Features & Benefits

- 100% acrylic
- Easy to clean
- Non-porous
- Stain resistant
- Mould & mildew resistant
- Suitable for residential & commercial applications
- Integral overflow : yes

### Installation Tips

- Undermount
- No tap holes
- Drain assembly not included
- Drain hole size: 45mm

### Available Colours

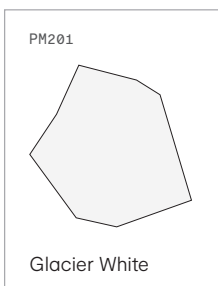

Colour shown may vary from actual product. Request sample prior to product selection. We'd love to create something a little more custom for you, longer lead times with minimum order quantity applies.

### Codes/Standards/Tech Info

- Durasein sinks and bowls are UKCA & CE compliant
- All dimensions are nominal
- Details and specifications are subject to change

### Internal Dimensions

- Length 370mm
- Width 265mm
- Height 135mm

### Durasein Limited Warranty

- 10 year limited warranty against manufacturing defects under normal use

See website for detailed warranty information. Durasein reserves the right to make reservations without notice to product specifications. For the most current information, for to [durasein.co.uk](http://durasein.co.uk).





# Durasein

## Sink & Bowl Information

NAME  
THE JEAN  
MODEL  
RLA319A  
TOLERANCE  
±5MM

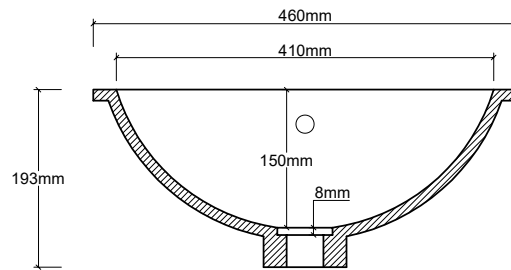
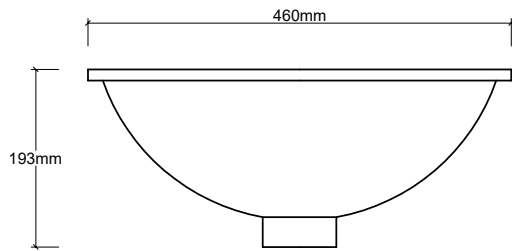

A-A

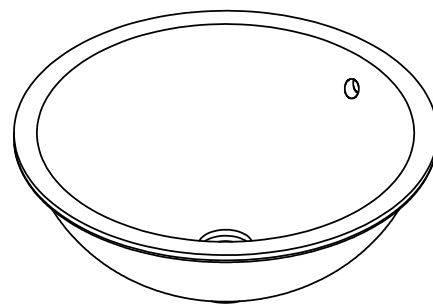
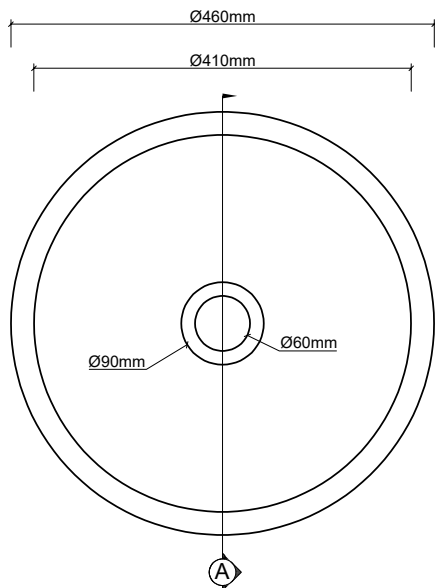



# Durasein

## Sink & Bowl Information

MODEL  
RLA319A

### Features & Benefits

- 100% acrylic
- Easy to clean
- Non-porous
- Stain resistant
- Mould & mildew resistant
- Suitable for residential & commercial applications
- Integral overflow : no ; overflow : yes

### Installation Tips

- Undermount
- No tap holes
- Drain assembly not included
- Drain hole size: 60mm

### Available Colours

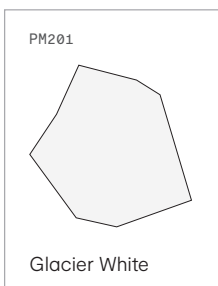

Colour shown may vary from actual product. Request sample prior to product selection. We'd love to create something a little more custom for you, longer lead times with minimum order quantity applies.

### Codes/Standards/Tech Info

- Durasein sinks and bowls are UKCA & CE compliant
- All dimensions are nominal
- Details and specifications are subject to change

### Internal Dimensions

- Length 410mm
- Width 410mm
- Height 150mm

### Durasein Limited Warranty

- 10 year limited warranty against manufacturing defects under normal use

See website for detailed warranty information. Durasein reserves the right to make reservations without notice to product specifications. For the most current information, for to [durasein.co.uk](http://durasein.co.uk).



# Durasein

## Sink & Bowl Information

NAME  
THE SALVADOR  
MODEL  
RLA351A  
TOLERANCE  
±5MM

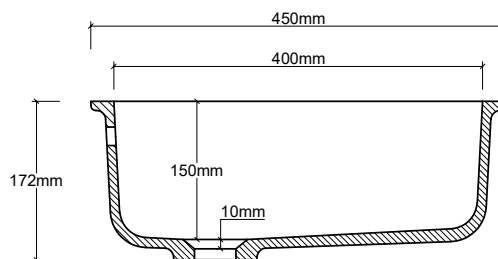
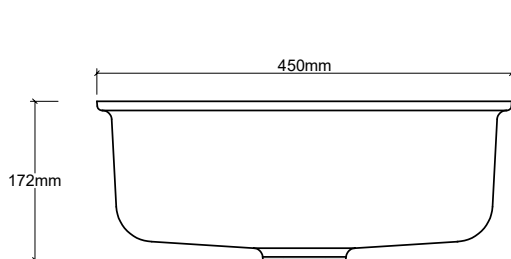

A-A

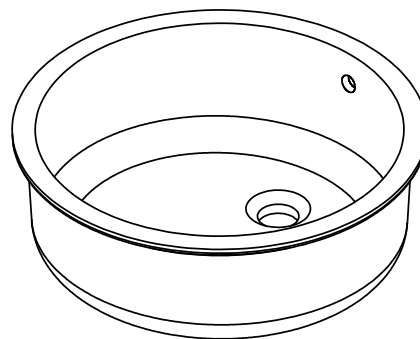
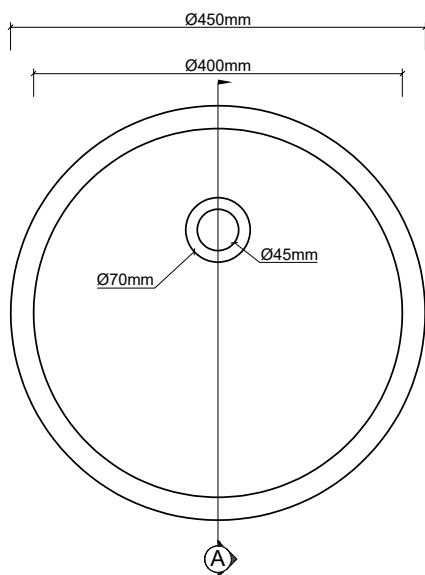



# Durasein

## Sink & Bowl Information

MODEL  
RLA351A

### Features & Benefits

- 100% acrylic
- Easy to clean
- Non-porous
- Stain resistant
- Mould & mildew resistant
- Suitable for residential & commercial applications
- Integral overflow : no ; overflow : yes

### Installation Tips

- Undermount
- No tap holes
- Drain assembly not included
- Drain hole size: 45mm

### Available Colours

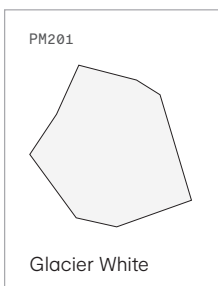

Colour shown may vary from actual product. Request sample prior to product selection. We'd love to create something a little more custom for you, longer lead times with minimum order quantity applies.

### Codes/Standards/Tech Info

- Durasein sinks and bowls are UKCA & CE compliant
- All dimensions are nominal
- Details and specifications are subject to change

### Internal Dimensions

- Length 400mm
- Width 400mm
- Height 150mm

### Durasein Limited Warranty

- 10 year limited warranty against manufacturing defects under normal use

See website for detailed warranty information. Durasein reserves the right to make reservations without notice to product specifications. For the most current information, for to [durasein.co.uk](http://durasein.co.uk).